

Addendum — Alfa Laval CM

Installation — LKH Centrifugal Pumps

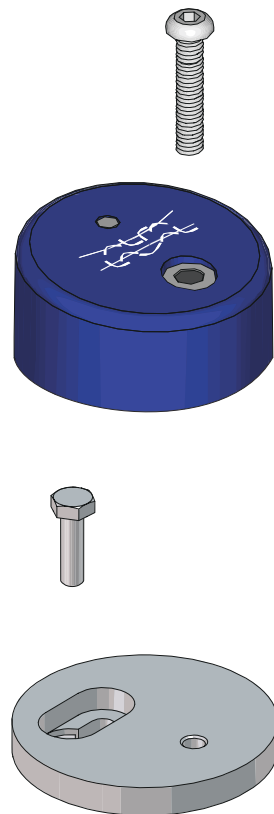

Lit. Code 200005431-1-EN-GB
Manual No. 100003844

Published by
Alfa Laval Kolding A/S
Albuen 31
DK-6000 Kolding, Denmark
+45 79 32 22 00

The original instructions are in English

© Alfa Laval Corporate AB 2021-06

This document and its contents are subject to copyrights and other intellectual property rights owned by Alfa Laval Corporate AB. No part of this document may be copied, re-produced or transmitted in any form or by any means, or for any purpose, without Alfa Laval Corporate AB's prior express written permission. Information and services provided in this document are made as a benefit and service to the user, and no representations or warranties are made about the accuracy or suitability of this information and these services for any purpose. All rights are reserved.

Contents

1	General Installation Guidelines.....	5
1.1	LKH guidelines.....	5
1.2	Hygienic recommendations.....	6
1.3	Adapter details.....	6

1 General Installation Guidelines

! NOTE

When mounting the CM, it is important to achieve a solid mechanical connection between the equipment and the CM adapter plate. The CM can be mounted on surfaces up to 80° C (176° F).

1.1 LKH guidelines

The CM is assembled on the top of the adapter

Moter size	Adapter type	Tool		Max torque [Adapter screw / CM screw]
		Spanner Adapter screw	Hex key CM screw	
IEC 80–90 NEMA 46–143–145	1	8mm	4mm	4.5 Nm / 8 Nm 3.3 ft-lb / 5.9 ft-lb
IEC 100–280 NEMA 182–405	2	8mm		4.5 Nm / 8 Nm 3.3 ft-lb / 5.9 ft-lb

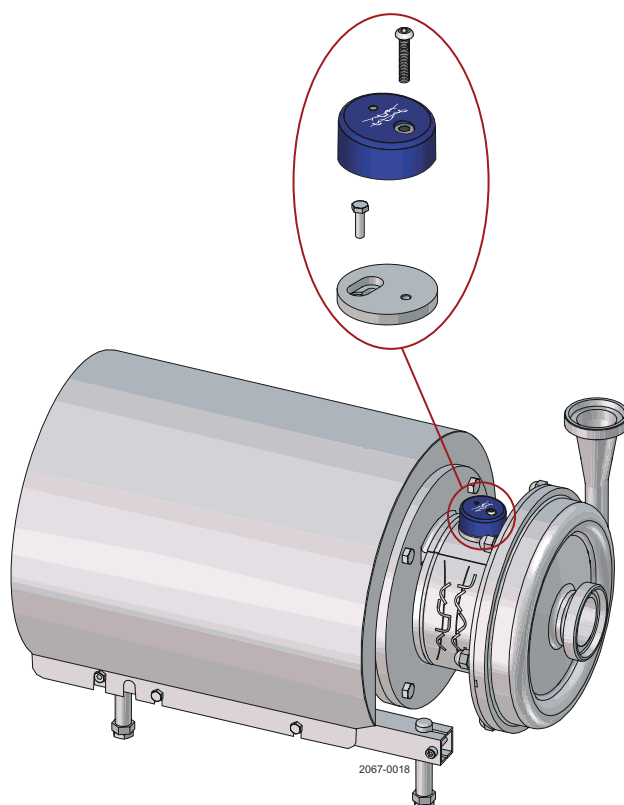

1.2 Hygienic recommendations

For a hygienic installation, use an FDA approved sealant between the equipment and the adapter plate, and between the CM and the adapter plate.

1.3 Adapter details

Type 1

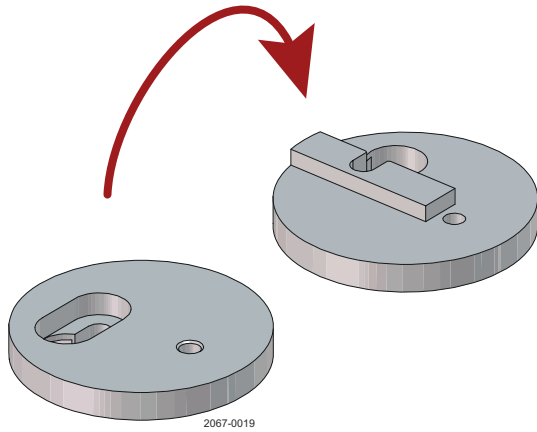

Type 2

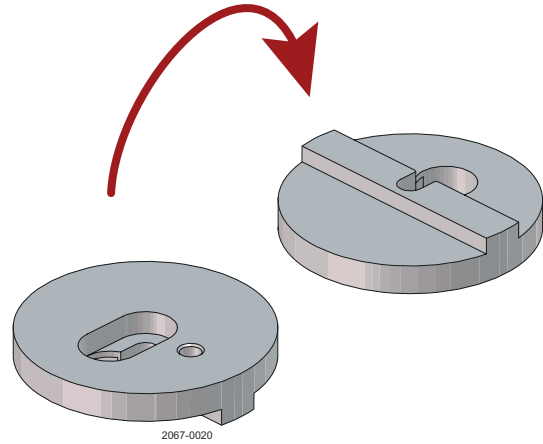

Adapter Kit [Type / Article No.]*	Adapter Screw Hex screw	Adapter Dimensions [Ø/H]	Adapter Weight
Type 1) 8010008558	M5 x 16	58mm / 11mm 2.3 in / 0.43in	0.13 kg 0.29 lbs
Type 2) 8010008557	M5 x 16	58mm / 11mm 2.3 in / 0.43in	0.13 kg 0.29 lbs

* All adapters are made of stainless steel EN 1.4301 (AISI 304).

* The CM is included.