



Minimizing the Risk of Tank Damage

Alfa Laval SB Pressure Relief Valve

Concept

The Pressure Relief Valve is used for minimizing the risk of damage to tanks due to liquid overfilling.

Working Principle

The Pressure Relief Valve is delivered with counter weight set and locked to suit customer requirements regarding opening pressure. When pressure in the tank exceeds the preset opening value, the valve relieves the excess pressure.

Standard Design

The Pressure Relief Valve is available in two versions:

- Integrated in a SCANDI BREW® tank top system
- Mounted on its own welding flange

Compliance to EN 4126-1

Compliance to EN 764-7

Compliance Pressure Equipment Directive 2014/68/EU of the European Community, Fluida Group II

The advantages of an integrated Pressure Relief Valve are lower initial costs, superior hygiene and smaller area required for the valve. The size and setting of the Pressure Relief Valve is based on the tank design data and process requirements.

TECHNICAL DATA

Nominal size	Set Pressure Range
75mm	0.2 - 3.5 bar
100mm	0.2 - 2.5 bar
150mm	0.4 - 1.5 bar



PHYSICAL DATA

Materials

Product wetted steel parts: . . . EN 1.4404 (AISI 316L) with 3.1 cert.
 Product wetted steel surfaces: . Surface roughness Ra<0.8 µm
 Product wetted seals: EPDM

Cleaning In Place (CIP)

The Pressure Relief Valve is cleaned in closed position by the tank cleaning head, but this will not include the valve seating. To include the valve seating in the cleaning cycle, there is the option to equip the valve with a pneum. force opener and a splash guard.

Integrated Valve

Options

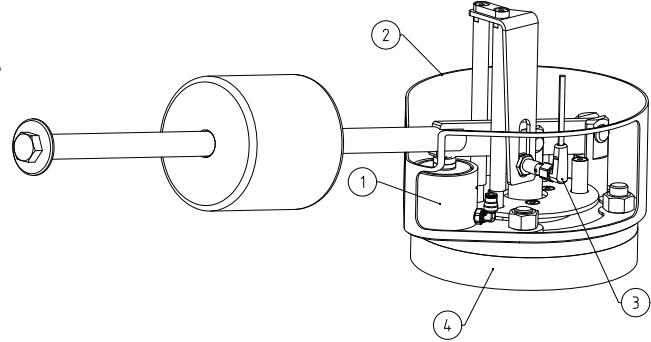
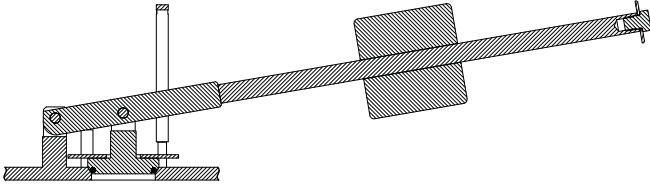

Options:

- Pos. 1: Force opener: force opening during cleaning cycle
- Pos. 2: Splash guard: containing CIP liquid during valve seat cleaning
- Pos. 3: Proximity sensor: for operation detection
- Pos. 4: Welding flange: for installation

Flange Mounted Valve

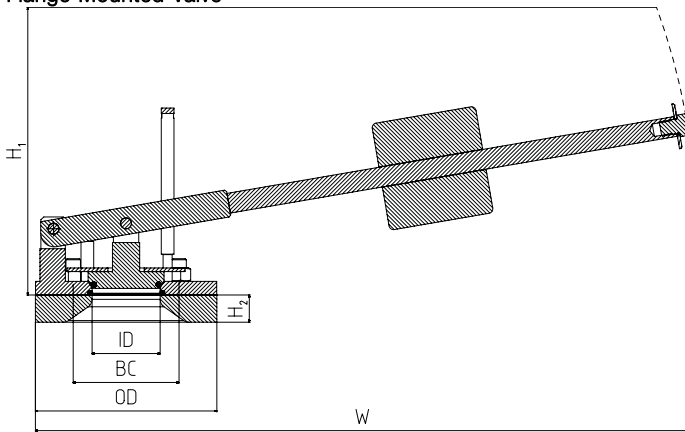

ID = Active diameter
 BC = Bolt circle
 OD = Outside diameter

Interface requirements (mm)

Nominal Size	ID	BC	OD	Bolts	H1	H2	W
75	75	165	200	4xM16	375	30	740
100	100	165	200	4xM16	375	30	740
150	150	230	270	8xM16	430	30	1050

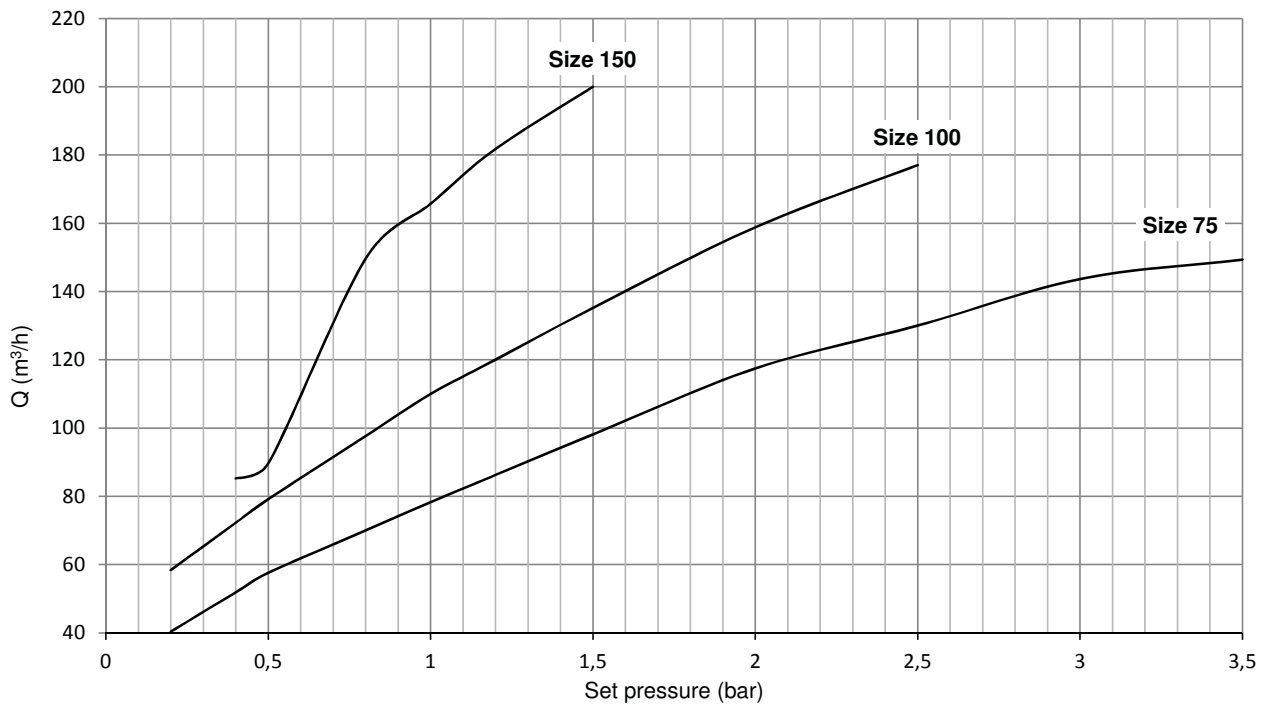

Discharge Capacity

In accordance with EN 4126-1

Capacity measured at:

$\Delta P=10\%$ Set pressure ≥ 1 bar

$\Delta P=0,1$ Set pressure < 1 bar

Medium: water (20°C)

Alfa Laval reserves the right to change specifications without prior notification. ALFA LAVAL is a trademark registered and owned by Alfa Laval Corporate AB.

ESE02913EN 1611

© Alfa Laval

How to contact Alfa Laval

Contact details for all countries are continually updated on our website. Please visit www.alfalaval.com to access the information direct.