



Positive displacement pumps

Preventive maintenance guidelines

Plan your budget and your downtime

A production stop caused by poor operation or breakdown is costly, both in lost production and expensive servicing.

The most cost-effective way to ensure product safety and production reliability is to plan and carry out service at scheduled intervals.

Using the Alfa Laval guidelines it is easy to plan the relevant maintenance intervals. You can plan your operating budget and the risk of breakdowns is virtually eliminated. Preventive maintenance makes sense financially.

Instruction manuals and service videos



Detailed manuals are supplied with every product. Service and maintenance videos have been created to enable you to service Alfa Laval products in a correct and efficient way. Scan the QR code to access the service videos.

Genuine spare parts and service kits



Alfa Laval Service Kits are available for scheduled maintenance. They contain all the relevant parts needed for general service. Using genuine Alfa Laval spare parts guarantees the right quality and composition of materials. Needless to say they come with full traceability. Scan the QR code to access the spare parts catalogue.



Alfa Laval service tools

Alfa Laval has the specific tools required to service Alfa Laval hygienic equipment. These include tools for installing, operating and maintaining our hygienic equipment.

Using genuine spare parts ensures your certificates are still valid.



Example of exploded view - OptiLobe

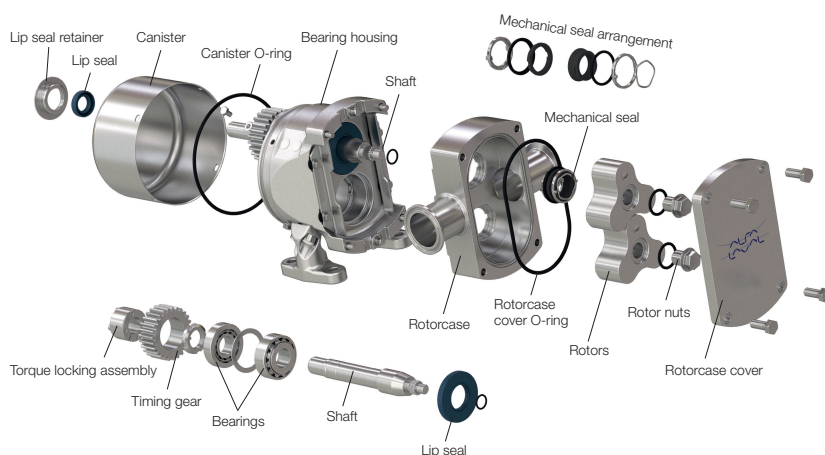

Inspect the pump regularly

The Alfa Laval pumps are available in various configurations to fit specific applications. To inspect the pump you need to know the type of pump. This information can be found on the name plate of your pump. Further information can be obtained online using the serial number.

Preventive maintenance aims to prevent equipment failures with e.g. regular inspection and lubrication. Based on experience and knowledge of running conditions it is also possible to replace wear parts before they fail. Keeping a maintenance log is a good way to build experience. It is advisable to install pressure gauges on both sides of the pump so that any problems within the pump/pipework can be monitored.

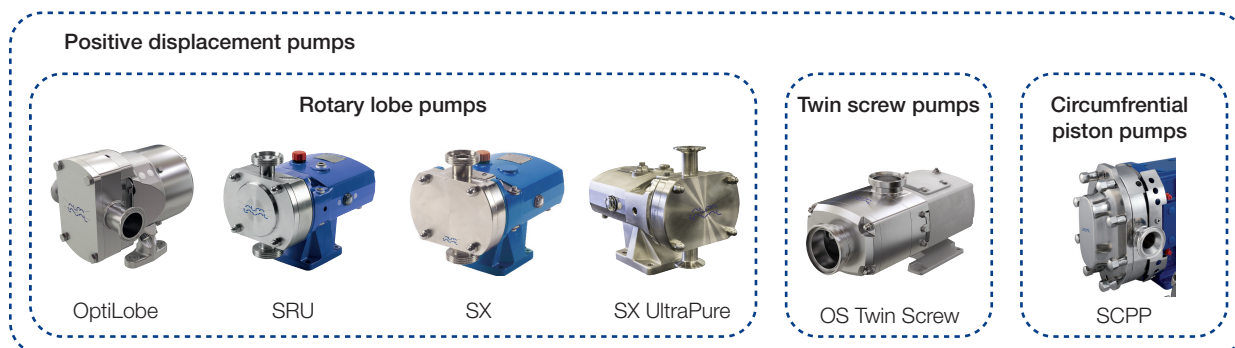

This preventive maintenance guidelines mainly cover positive displacement pumps as below:

	Inspect / Clean / Lubricate			
	Supplier Instruction	Weekly	Monthly	Half-yearly
OptiLobe, SRU, SX & SX UltraPure, Twin Screw, SCPP				
Check the seals for leakage		x		
Check the lip seals for leakage		x		
Check pumping pressures		x		
SRU, SX, & SX UltraPure				
Check the oil seals for leakage		x		
Check the oil level in the gearcase with pump stationary		x		
Drive unit / all types of pump	x			

Scheduled maintenance intervals

To ensure that your pumps operate efficiently, it is essential to follow a simple preventive maintenance programme, which will keep your machine in good working order. Good maintenance requires careful attention at regular intervals. For pump lubrication, please always refer to the manual for specific information on oil/grease types and required maintenance. Please check whether the positive displacement pump is supplied pre-filled with oil. **Alfa Laval recommends:**

- Replace service kit for all positive displacement pumps every 12 months.
- SRU / SX: change oil every 3000 hours of pump operation.
- OptiLobe: change grease every 20000 hours of pump operation.
- OS Twin Screw: change oil every 4000 hours of pump operation.
- SCPP: change oil every 750 hours.

The above guidelines may not apply in all working condition.

Please contact Alfa Laval for information relating to specific applications.

Alfa Laval reserves the right to change specifications without prior notification.

How to contact Alfa Laval

Contact details for all countries are continually updated on our website. Please visit www.alfalaval.com to access the information direct.