

## CARLSBERG FLASK

**ART. NO. 200001**

### GENERAL

The Carlsberg Flask is used for the propagation of yeast cultures in a sterile environment and the transfer of the pure yeast culture under sterile conditions ensuring contamination-free culture development.

### FLASK FEATURES

- Sterilization of flask environment and fermentation media by hot plate, external flame, or autoclave
- Dual-action tank inlet valve for vessel protection and sterile air supply without loss of pressure or exposure to atmospheric conditions
- Inoculation /extraction septum valve
- Patented sterile transfer valve and sterile hose assemblies
- Vessel pressure gauge
- Vessel temperature gauge

### FLASK BENEFITS

- Effective environment sterilization for contamination-free propagation
- Method of inoculation, culture transfer and vessel protection never compromises culture sterility
- Flask environment conditions can be monitored for ideal fermentation conditions
- Patented transfer valve with transfer system

### TECHNICAL SPECIFICATION

- Approx. 30 liter standard gross sizes – other sizes available on request
- 316L material of construction
- Electro-polished finish 5-10 RA
- Dimensions: 30 liter - 660 mm (height) - Ø300 mm
- Comes complete with vessel, pressure relief valve / Sterile air injection valve, sterile filter housing, sterile filter cartridges, inoculation septum, pressure gauge, temperature gauge, sterile transfer valve, 3 ft transfer line with stainless couplings

### FLASK METHOD

- The flask can be sterilized with water prior to introduction of the base media or base media can be sterilized in the flask from the start.
- All the related tank components can be sterilized in-situ as the flask contents are brought to a boil for sterilization.
- Pressure and cool down temps can be monitored.
- Inoculation is done through the septum valve with syringe, through the transfer valve via needle-less syringe, or sterile transfer bag.
- Transfers are done in a pre-sterilized transfer path.



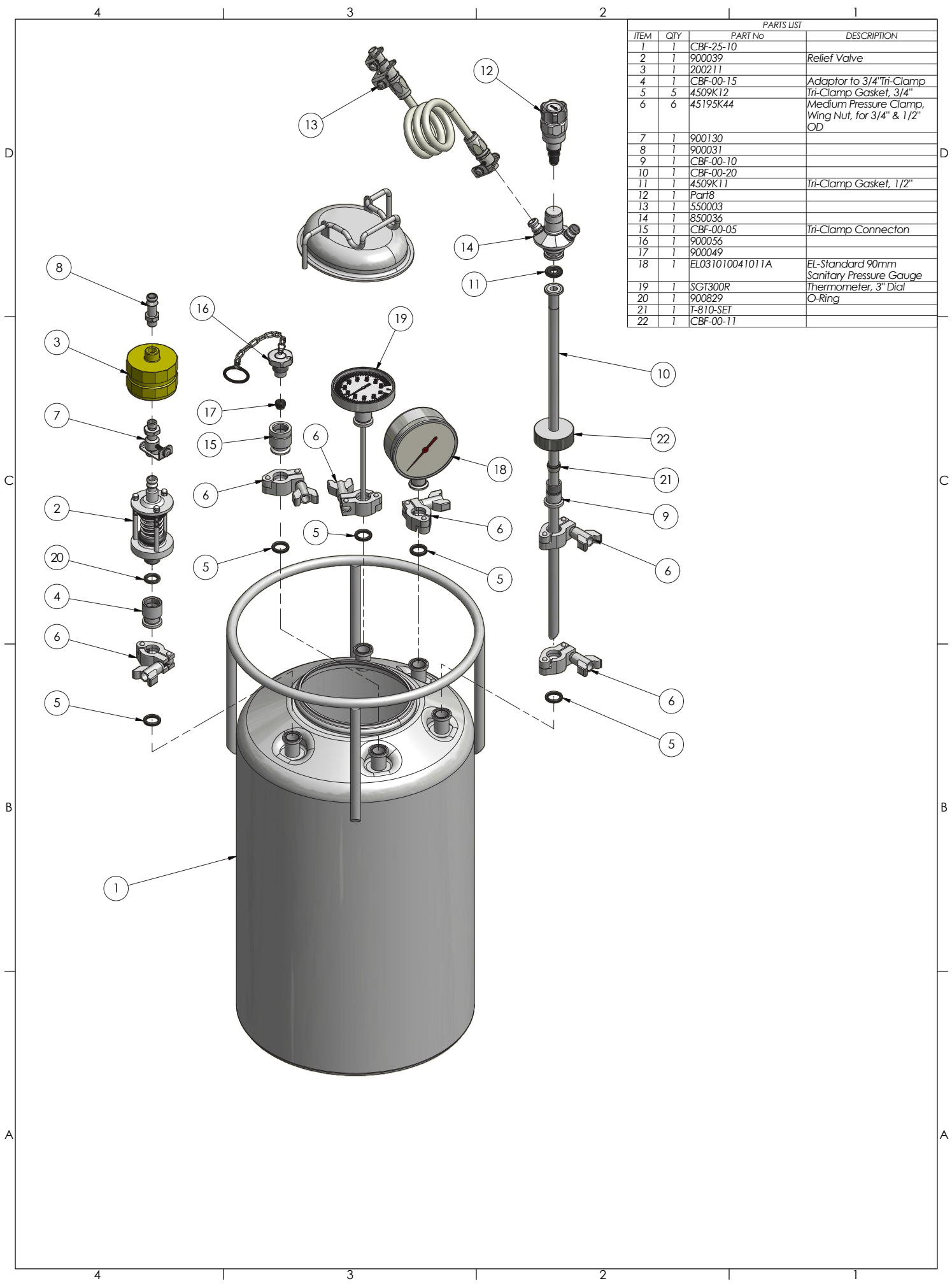

PARTS LIST			
ITEM	QTY	PART No	DESCRIPTION
1	1	CBF-25-10	
2	1	900039	Relief Valve
3	1	200211	
4	1	CBF-00-15	Adaptor to 3/4" Tri-Clamp
5	5	4509K12	Tri-Clamp Gasket, 3/4"
6	6	45195K44	Medium Pressure Clamp, Wing Nut, for 3/4" & 1/2" OD
7	1	900130	
8	1	900031	
9	1	CBF-00-10	
10	1	CBF-00-20	
11	1	4509K11	Tri-Clamp Gasket, 1/2"
12	1	Part8	
13	1	550003	
14	1	850036	
15	1	CBF-00-05	Tri-Clamp Connector
16	1	900056	
17	1	900049	
18	1	EL031010041011A	EL-Standard 90mm Sanitary Pressure Gauge
19	1	SGT300R	Thermometer, 3" Dial
20	1	900829	O-Ring
21	1	T-810-SET	
22	1	CBF-00-11	