



# Keep an Eye on your Product

## LKGG-1 and LKGL-1 In-Line Sight Glass

PD 65083 GB4 2002-02

### Application

In-line sight glass type LKGG-1 and LKGL-1 is used in pipelines to allow visual observation of product flow.

### Standard design

LKGG-1 consists of a perforated stainless steel shield tube fitted with a welding union at each end. A special glass tube is fixed in the shield tube so that it is unaffected by possible stresses in the pipelines.

LKGL-1 has a stainless steel light fitting unit welded onto the shield tube so that the product flow can be illuminated.

### Materials

Seals:	EPDM rubber.
Steel grade:	Stainless steel AISI 304 or acid-resistant steel AISI 316.
Glass:	Borosilicate.

### Sizes

25 mm (1"), 38 mm (1½"), 51 mm (2"), 63.5 mm (2 ½") and 76 mm (3").

### Technical data

Max. test pressure (20°C):	500 kPa (5 bar).
Recommended max.	
Working temperature:	110°C.
Max. thermal shock:	100°C.
Bulb:	24 V / 24 W.
Bulb socket:	B 15.

### Options

#### Material grades

A) Seals of Nitrile (NBR).

### Ordering

Please state the following when ordering:

- Materials, AISI 304 or 316.
- Type: LKGG-1 or LKGL-1.
- Size.



Upper: LKGG-1, In-line sight glass.  
Lower: LKGL-1, In-line sight glass.

**Dimensions (mm)**

Size	25mm	38mm	51mm	63.5mm	76.1mm	101.6mm
A	175	181	188	194	200	-
B	64	77	91	106	122	148
OD	26.2	38.9	51.6	64.3	76.6	102
ID	22.5	35.5	48.5	60.5	72	97.6
t	1.85	1.7	1.55	1.9	2.3	2.2
Weight (kg)	1.0	1.5	2.0	2.5	3.6	-

**Note!** - LKGL-1: +0.5 kg  
 - Size 101.6mm only for LKGG-1

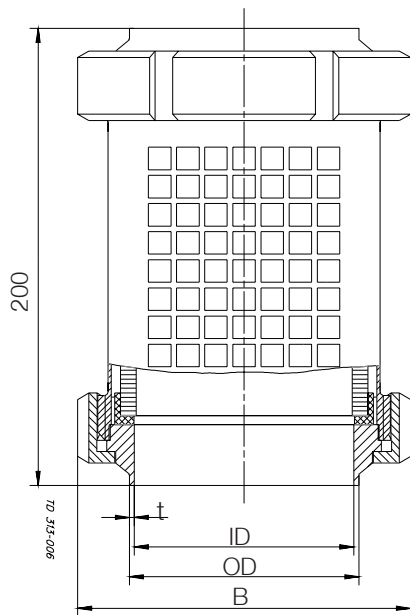

a. LKGG-1.

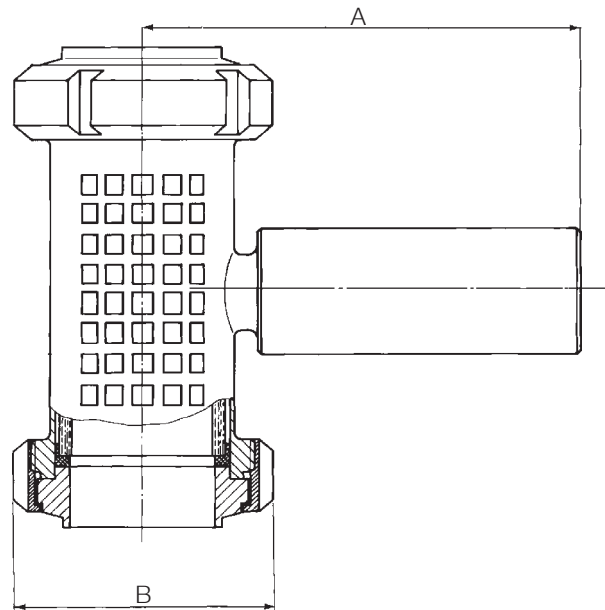

b. LKGL-1.

Fig. 3. Dimensions.

**How to contact Alfa Laval**

Contact details for all countries are continually updated on our website. Please visit [www.alfalaval.com](http://www.alfalaval.com) to access the information direct.